



FISCHER

MULCHER | TAGLIAERBA | MOWER

VARIANTEN

VERSIONI VARIANT

GL4W



Fixer Heckanbau
Attacco fisso posteriore
Fix rear mounting

GL4W-F

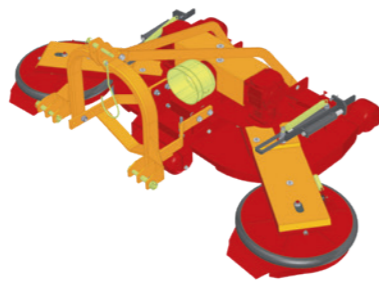

Fixer Frontanbau
Attacco fisso frontale
Fix front mounting

GL4W-H



Heckanbau mit hydraulischer
Linearverschiebung
Spostamento idraulico
Hydraulic side shift



GL4 W

SCHONEND UM DEN REBSTOCK

IL TAGLIAERBA PER LA VIGNA

GENTLY AROUND THE VINE



GL4W

GL4W

SERIENAUSSTATTUNG ACCESSORI DI SERIE STANDARD EQUIPMENT ZUSATZAUSRÜSTUNG ACCESSORI ADDITIONAL EQUIPMENT

DE

Zapfwelle 540/
 Laufwalze und Laufräder höhenverstellbar (4-7cm)
 Gegenläufiger Getriebeantrieb der Messerrotoren
 Gepolsterte, drehbare Schwenkscheiben mit Federzug
 Hydraulischer Schwenkarmeinzug beidseitig (ein Zylinder > GL4 110 - 140)
 Hydraulischer Schwenkarmeinzug beidseitig (zwei Zylinder > GL4 160 - 220)
 Gelagertes Gleitteller an den Schwenkscheiben
 Gelenkwelle CE mit Überlastungskupplung und Freilauf
 Bewegliche Messer auf dem Grundgerät und den Schwenkarmen

FÜR SERIENAUSSTATTUNG AUF TRAKTOR NOTWENDIG:
 1 DW Steuergerät für Schwenkarmeinzug (GL4W-110-140)
 2 DW Steuergeräte für Schwenkarmeinzug (GL4W-160-220)

IT

PTO 540/min
 Ruote e rullo regolabili in altezza (4-7cm)
 Contro rotazione dei rotori con lame snodate
 Dischi interfilari girevoli con protezione in gomma a molla
 Rientro idraulico dei bracci (un cilindro > GL4 110 - 140)
 Rientro idraulico dei bracci (due cilindri > GL4 160 - 220)
 Fondelli con cuscinetto a sfera su rotori
 Albero cardanico CE con frizione e ruota libera
 Lame mobili sulla macchina e sui bracci interfilari



PER MACCHINA DI SERIE SU TRATTORE NECESSARIO:
 1 distributore doppio effetto per il rientro idraulico dei bracci (GL4W-110-140)
 2 distributori doppio effetto per il rientro idraulico dei bracci (GL4W-160-220)

EN

PTO 540/min
 Wheel rollers height - adjustable (4-7 cm)
 Counter-rotating gearbox drive of the blade rotors
 Cushioned rotating swing wings with spring-drawing attachment
 Hydraulic swing arm retraction both sides (one cylinder > GL4 110 - 140)
 Hydraulic swing arm retraction both sides (two cylinder > GL4 160 - 220)
 Mounted slide disk on the swing wing
 PTO drive shaft CE with overload clutch and freewheeling
 Mobile blades on main frame and swing arms

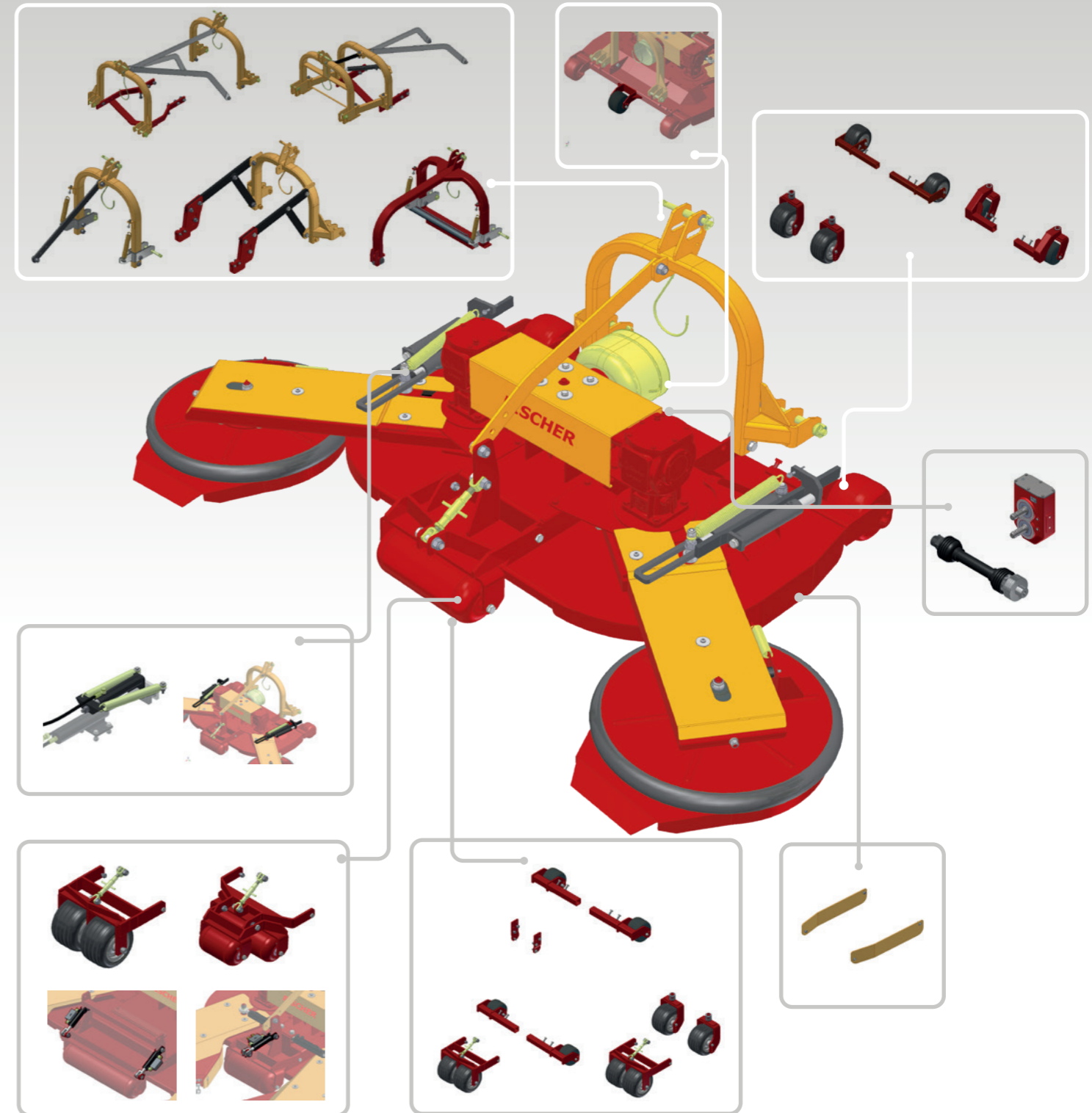
FOR STANDARD EQUIPMENT ON TRACTOR NEEDED:
 1 double acting control unit for hyd. swing arm retraction (GL4W-110-140)
 2 double acting control units for hyd. swing arm retraction (GL4W-160-220)

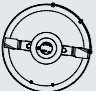
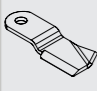

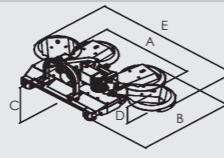
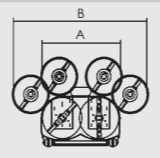
Mod.											
					A	B	C	D	E	A	B
GL/4 45 110-190	4	8	30 - 80	380	121	162	94	25	195	116	190
GL/4 45 120-200	4	8	30 - 80	430	126	144	94	25	207	121	202
GL/4 45 130-210	4	8	30 - 80	490	135	149	94	25	218	130	213
GL/4 45 140-220	4	8	30 - 80	530	143	154	94	25	228	138	223
GL/4 60 140-245	4	8	30 - 80	540	164	173	94	25	262	155	253
GL/4 60 160-265	4	8	30 - 80	560	165	178	94	25	275	159	266
GL/4 60 180-285	4	8	40 - 80	590	183	185	94	25	294	176	286
GL/4 60 200-305	4	8	50 - 80	630	204	196	94	25	315	200	307
GL/4 60 220-325	4	8	50 - 80	670	223	211	94	25	335	217	326
GL/4 60 240-345	4	8	60 - 120	700	245	221	94	25	356	239	347